

# Rough Draft

If questions, especially "why did he do \*that\*?", "that's a silly thing to do!", or "that's gonna cost a bundle!", call 503-784-3532 or email alan@batie.org

Drawing is intended to show significant modifications and preferences - if drawing shows slight variation from standard model, it's probably just the best I could do with this drafting program.

Punch Professional format file at:  
<http://alan.batie.org/architecture/palm-harbor/buckeye-extended.pro>

PDF of drawings at:  
<http://alan.batie.org/architecture/palm-harbor/buckeye-extended-house.pdf>  
<http://alan.batie.org/architecture/palm-harbor/buckeye-extended-electrical.pdf>  
<http://alan.batie.org/architecture/palm-harbor/buckeye-extended-plumbing.pdf>

PDF of plot layout at:  
<http://alan.batie.org/architecture/palm-harbor/buckeye-extended-plot.pdf>

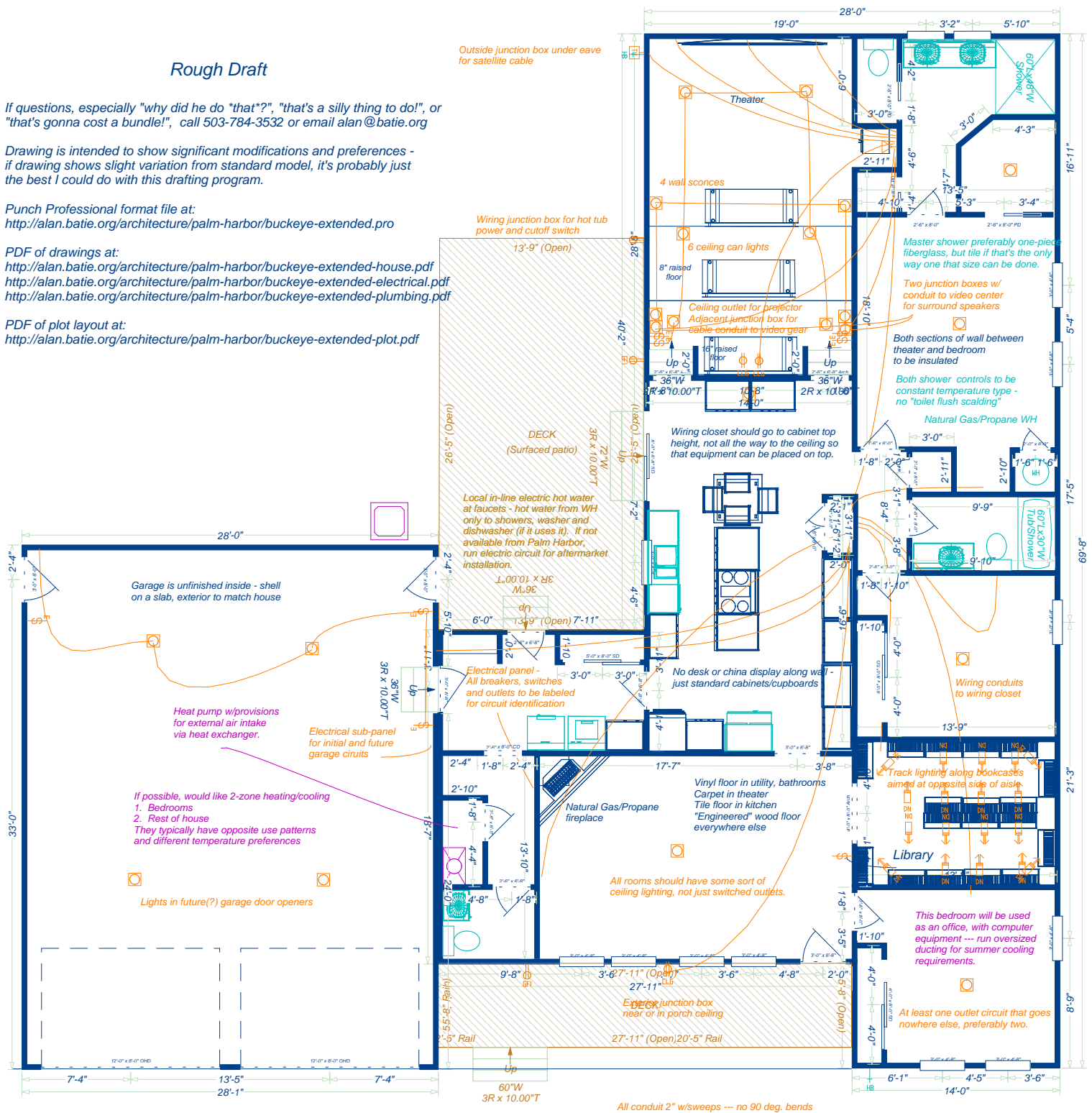

- Theater Video Center conduits:
1. Left front speaker
  2. Center speaker
  3. Right front speaker
  4. Left rear surround
  5. Right rear surround
  6. Projector ceiling mount
  7. Exterior satellite mount
  8. Kitchen wiring closet
- Plus telephone jack and separate power circuit.
- Kitchen wiring closet conduit connections:
1. Theater video center
  2. Master bedroom
  3. Guest bedroom
  4. Library (2' from kitchen wall along guest bedroom wall to avoid blockage by bookcases)
  5. Office bedroom
  6. Living room (along utility room wall)
  7. Pantry (ceiling, kitchen side)
  8. Exterior junction box, utility room, garage side
  9. Front porch ceiling